

### HOW TO ORDER

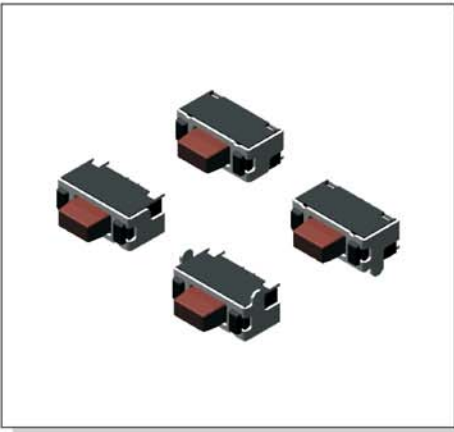
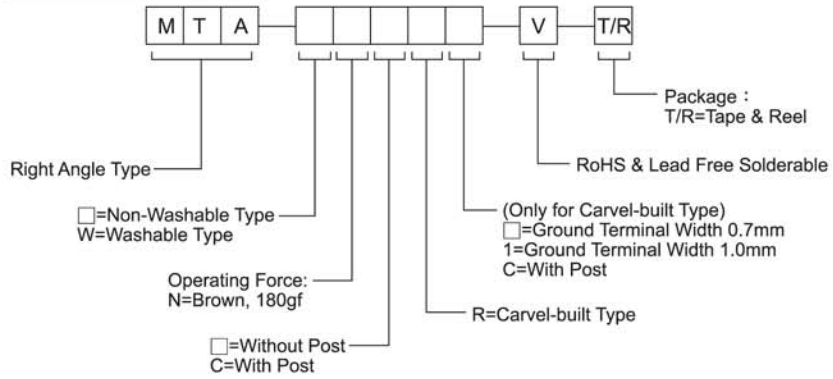

### SPECIFICATION

#### MECHANICAL

Mechanical Life : 50,000 cycles  
Operation Force : 180±50gf  
Stroke : 0.2±0.1mm

#### ENVIRONMENTAL

Operation Temperature Range : -30°C to +80°C  
Storage Temperature Range : -40°C to +90°C

#### ELECTRICAL

Electrical Life: 50,000 cycles  
Switching Rating: 50 mA, 12 VDC

#### PACKAGE

3000 pcs/reel

#### PACKAGE

3000 pcs/reel

### CIRCUIT

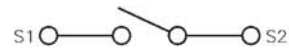

### MTA-N

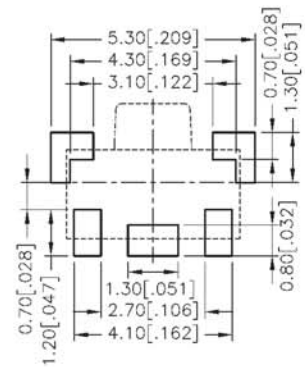
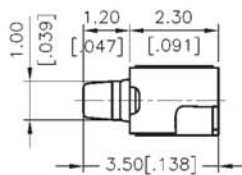
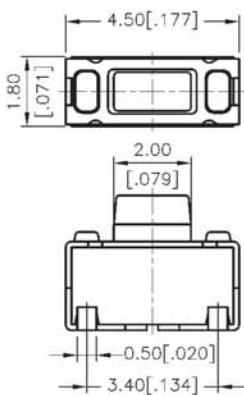

P.C.B. LAYOUT

### MTA-NC

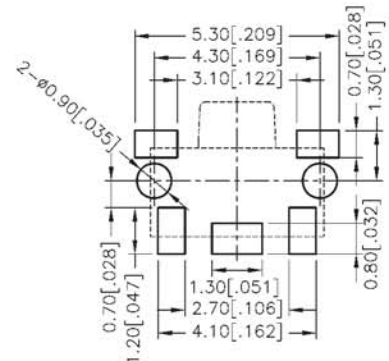
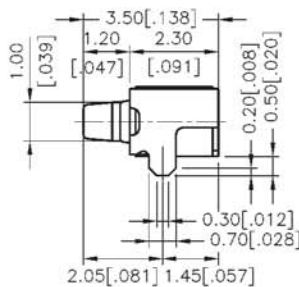
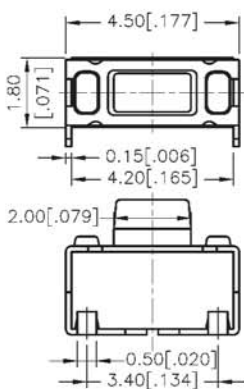

P.C.B. LAYOUT

General Tolerance: ±0.2mm(±0.008")